



 Machine roomless

 Gearless

 320-1000 kg

 1,0 - 1,6 m/s

 30 m

 2:1 or 1:1

 Single or 180 degree
or 90 degree double
entrance

 L type Cabin Frame

 EN 81-20 / EN 81-50
EN 81-21 / EN 81-28
EN 81-70

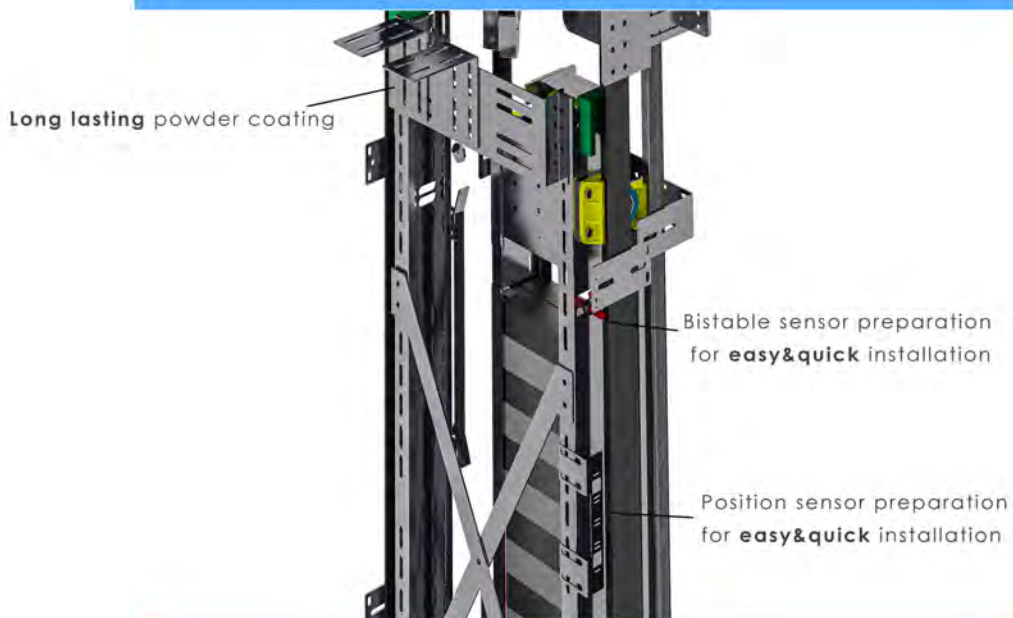
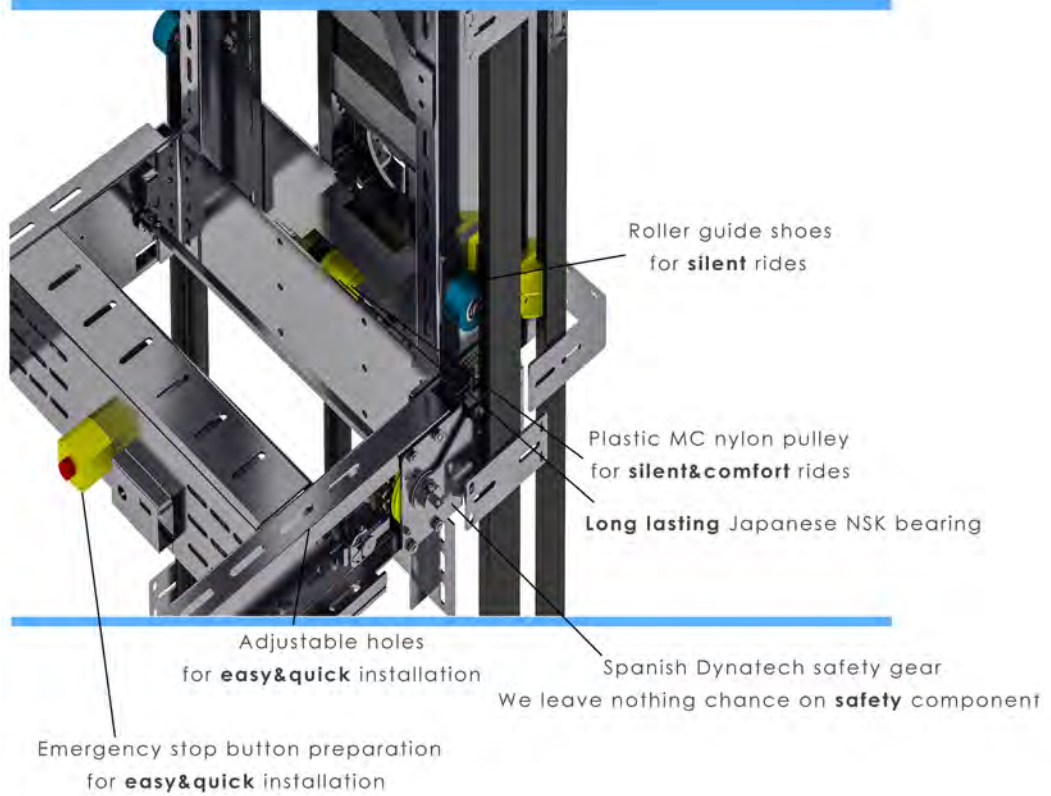

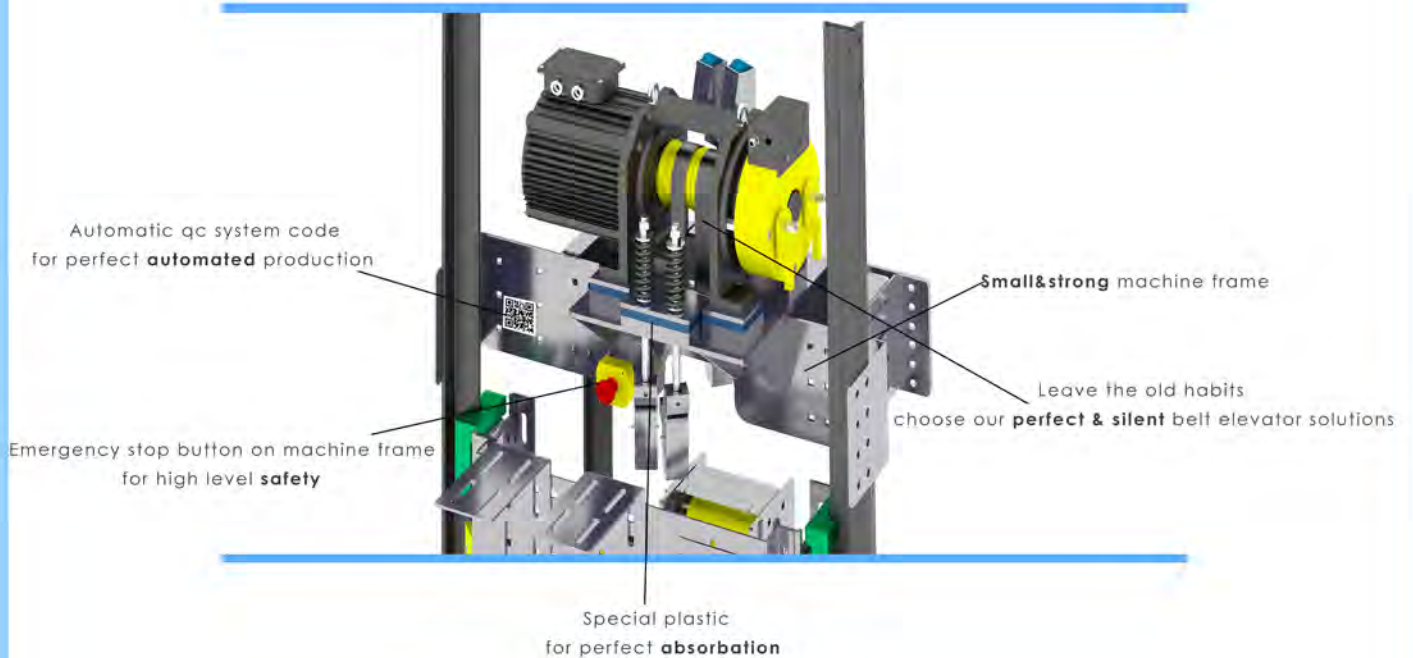

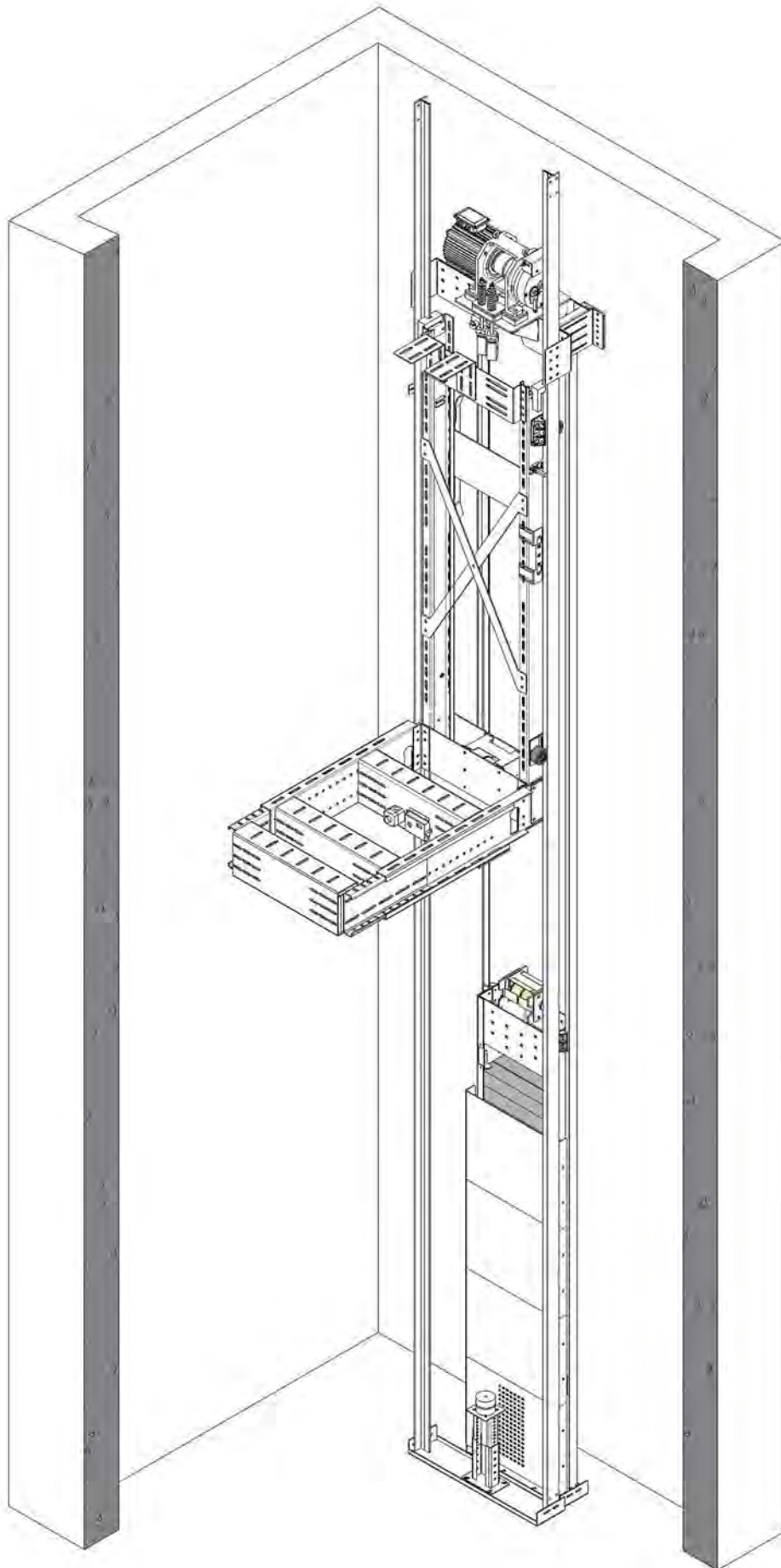

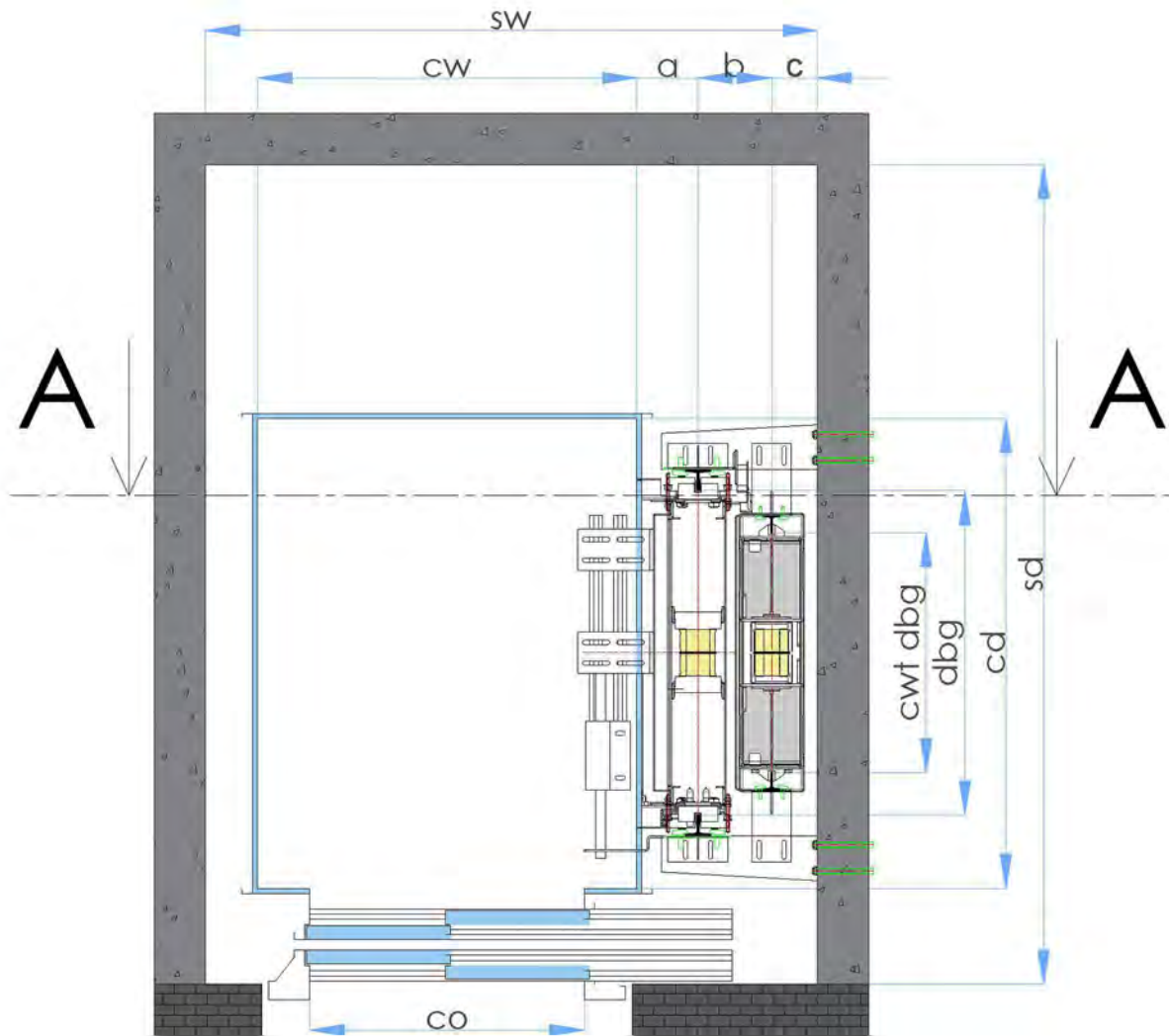

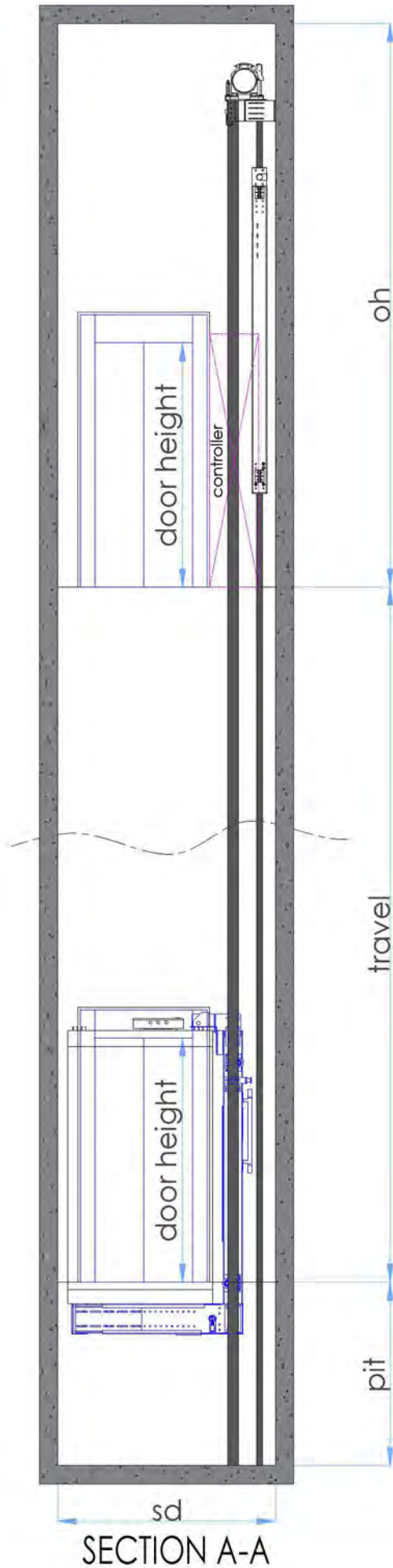

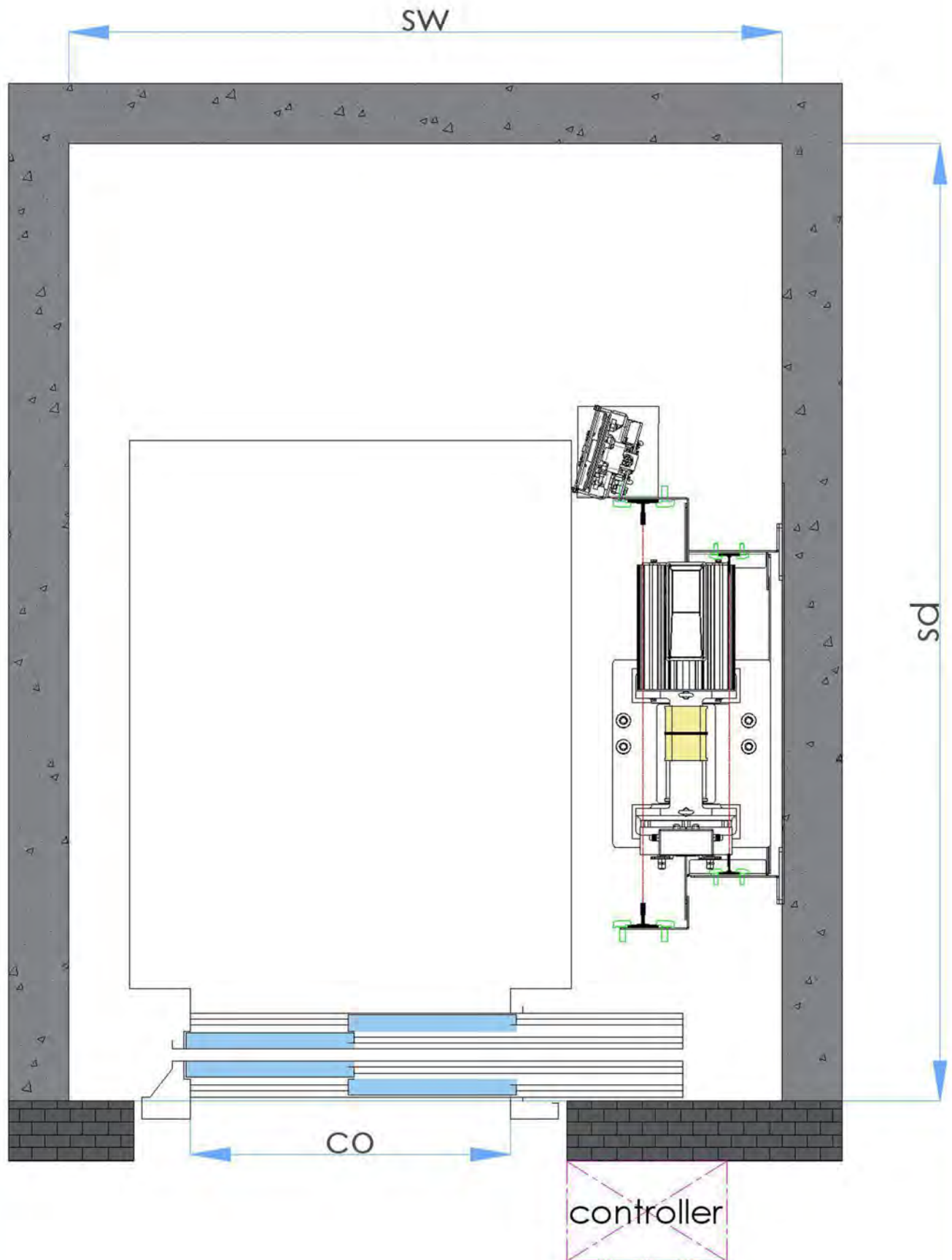

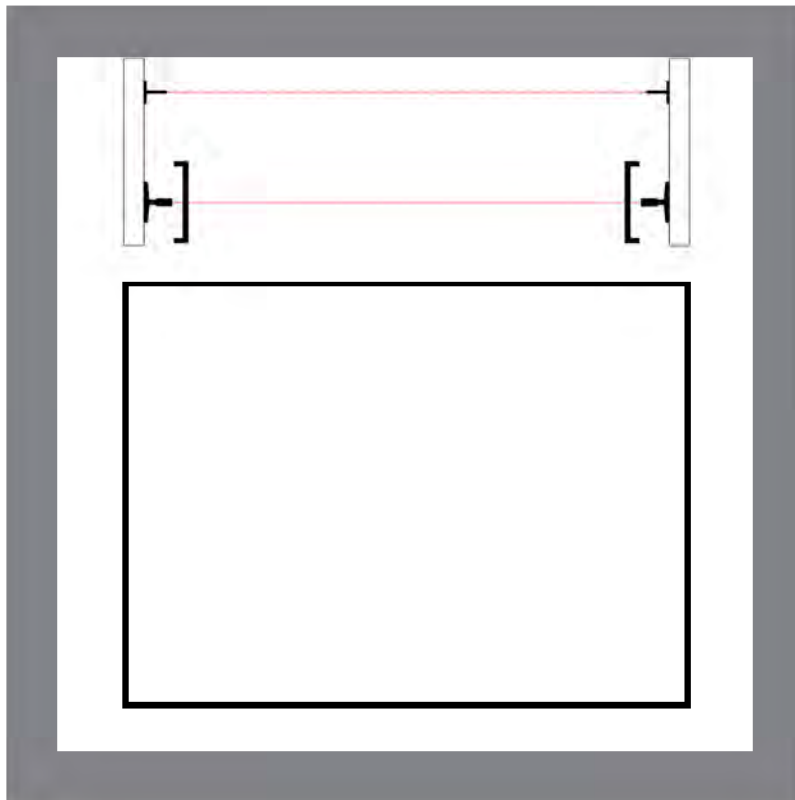

2000 A (ROPE / BELT)

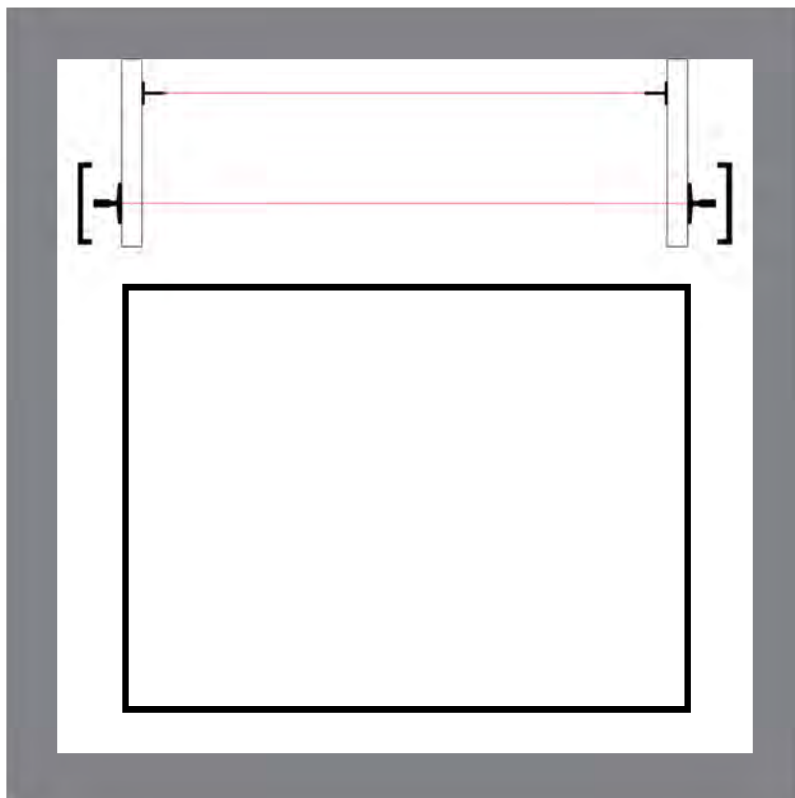

2000 B (ROPE / BELT)

MODEL 2000 - BELT

Technical Tables
1 m/s | Dimensions

capacity	320 kg	400 kg	450 kg	630 kg	800 kg
no of passengers	4	5	6	8	10
roping	2:1	2:1	2:1	2:1	2:1
total load, P+Q [kg]	960	1100	1225	1415	1650
max. car area [m ²]	0,9	1,17	1,3	1,66	2
min. car area [m ²]	0,79	0,98	1,17	1,45	1,73
For Option A:					
shaft width [mm]	1450	1500	1500	1600	1850
shaft depth [mm]	1550	1550	1550	1800	1800
minimum pit depth (mm) EN81-20	1050	1050	1050	1050	1050
minimum headroom (mm) EN81-20	3400	3400	3400	3400	3400
minimum pit depth (mm) EN81-21	655	655	655	655	655
minimum headroom (mm) EN81-21	2675	2675	2675	2675	2675
For Option B:					
shaft width [mm]	1250*	1350*	1350*	1450	1850
shaft depth [mm]	1400	1500	1600	1800	1800
minimum pit depth (mm) EN81-20	1050	1050	1050	1050	1050
minimum headroom (mm) EN81-20	3400	3400	3400	3400	3400
minimum pit depth (mm) EN81-21	275 (1)	275 (1)	275 (1)	350 (1)	350 (1)
minimum headroom (mm) EN81-21	2625 (2)	2625 (2)	2625 (2)	2625 (2)	2625
car width [mm]	900	1000	1000	1100	1350
car depth [mm]	1000	1100	1200	1400	1400
car internal height [mm]	2115	2115	2115	2115	2115
door type	2P side opening	2P side opening	2P side opening	2P side opening	2P side opening
door width [mm]	800	800	800	900	900
door height [mm]	2000	2000	2000	2000	2000
door total length [mm]	1250	1250	1250	1400	1400
car frame DBG [mm]	800	800	800	900	900
brace rods					

{1} SW-CW 450mm or OH min 3300mm {2} SW-CW 450mm

Motor & Inverter

capacity	320 kg	400 kg	450 kg	630 kg	800 kg
motor model	MB63	MB63	MB63	MB63	MB80
motor power [kW]	4,1	4,1	4,1	4,1	5,1
nominal current [A] for 380V	10	10	10	10	12
inverter model for 380V	14A	14A	14A	14A	14A
motor static load [kg]	2000	2000	2000	2000	2000
traction sheave [mm]	100	100	100	100	100
no of belt	2	2	2	3	3
width of belt [mm]	30	30	30	30	30
min. breaking load of belt [N]	42000	42000	42000	42000	42000
belt unit weight [kg/m]	0,25	0,25	0,25	0,25	0,25

Safety Components

capacity	320 kg	400 kg	450 kg	630 kg	800 kg
safety gear model	PRO 2000	PRO 2000	PRO 2000	PRO 2000	PRO 2000
safety gear P+Q [kg]	2400	2400	2400	2400	2400
buffer model	EYL-1	EYL-1	EYL-1	EYL-1	EYL-1
buffer P+Q [kg]	2250	2250	2250	2250	2250
OSG model	OSG M	OSG M	OSG M	OSG M	OSG M
dia of OSG pulley [mm]	120	120	120	120	120
tripping speed [m/s]	1,4	1,4	1,4	1,4	1,4
tension pulley model	OSG M	OSG M	OSG M	OSG M	OSG M
dia of tension pulley [mm]	120	120	120	120	120
dia of OSG rope [mm]	6,5	6,5	6,5	6,5	6,5
OSG rope composition	8*19 warrington	8*19 warrington	8*19 warrington	8*19 warrington	8*19 warrington
Tmin of OSG rope [N]	31500	31500	31500	31500	31500

MODEL 2000 - ROPE

Technical Tables
1 m/s | Dimensions

capacity	320 kg	400 kg	450 kg	630 kg	800 kg	1000 kg
no of passengers	4	5	6	8	10	13
roping	2:1	2:1	2:1	2:1	2:1	2:1
total load, P+Q [kg]	960	1100	1225	1415	1650	2000
max. car area [m ²]	0,9	1,17	1,3	1,66	2	2,4
min. car area [m ²]	0,79	0,98	1,17	1,45	1,73	2,15
For Option A:						
shaft width [mm]	1450	1500	1500	1600	1850	1950
shaft depth [mm]	1550	1550	1550	1800	1800	2000
minimum pit depth (mm) EN81-20	1050	1050	1050	1050	1050	1050
minimum headroom (mm) EN81-20	3400	3400	3400	3400	3400	3400
minimum pit depth (mm) EN81-21	655	655	655	655	655	655
minimum headroom (mm) EN81-21	2675	2675	2675	2675	2675	2675
For Option B:						
shaft width [mm]	1250*	1350*	1350*	1450	1850	1950
shaft depth [mm]	1400	1500	1600	1800	1800	2000
minimum pit depth (mm) EN81-20	1050	1050	1050	1050	1050	1050
minimum headroom (mm) EN81-20	3400	3400	3400	3400	3400	3400
minimum pit depth (mm) EN81-21	275 (1)	275 (1)	275 (1)	350 (1)	350 (1)	350 (1)
minimum headroom (mm) EN81-21	2625 (2)	2625 (2)	2625 (2)	2625 (2)	2625	2625
car width [mm]	900	1000	1000	1100	1350	1400
car depth [mm]	1000	1100	1200	1400	1400	1600
car internal height [mm]	2115	2115	2115	2115	2115	2115
door type	2P side opening	2P side opening	2P side opening	2P side opening	2P side opening	2P side opening
door width [mm]	800	800	800	900	900	900
door height [mm]	2000	2000	2000	2000	2000	2000
door total length [mm]	1250	1250	1250	1400	1400	1400
car frame DBG [mm]	800	800	800	900	900	900
brace rods						

(1) SW-CW 450mm or OH min 3300mm (2) SW-CW 450mm

Motor & Inverter

capacity	320 kg	400 kg	450 kg	630 kg	800 kg	1000 kg
machine model	AK1	AK1	AK2	AK2	AK2	AK3
machine power [kW]	2	2,4	2,9	3,9	4,9	6,1
nominal current [A] for 380V	5,2	6,5	7,8	10,2	13	16,3
inverter model for 380V	14 A	14 A	14 A	14 A	14 A	17 A
machine static load [kg]	7000	7000	7000	7000	7000	7000
traction sheave [mm]	210	210	210	210	210	210
no of ropes	3	3	4	7	8	9
dia of ropes [mm]	6,5	6,5	6,5	6,5	6,5	6,5
rope composition	8*19 warrington	8*19 warrington	8*19 warrington	8*19 warrington	8*19 warrington	8*19 warrington
min. breaking load of ropes [N]	31500	31500	31500	31500	31500	31500
rope unit weight [kg/m]	0,173	0,173	0,173	0,173	0,173	0,173

Safety Components

capacity	320 kg	400 kg	450 kg	630 kg	800 kg	1000 kg
safety gear model	PRO 2000	PRO 2000	PRO 2000	PRO 2000	PRO 2000	PRO 2000
safety gear P+Q [kg]	2400	2400	2400	2400	2400	2400
buffer model	EYL-1	EYL-1	EYL-1	EYL-1	EYL-1	EYL-1
buffer P+Q [kg]	2250	2250	2250	2250	2250	2250
OSG model	OSG M	OSG M	OSG M	OSG M	OSG M	OSG M
dia of OSG pulley [mm]	120	120	120	120	120	120
tripping speed [m/s]	1,4	1,4	1,4	1,4	1,4	1,4
tension pulley model	OSG M	OSG M	OSG M	OSG M	OSG M	OSG M
dia of tension pulley [mm]	120	120	120	120	120	120
dia of OSG rope [mm]	6,5	6,5	6,5	6,5	6,5	6,5
OSG rope composition	8*19 warrington	8*19 warrington	8*19 warrington	8*19 warrington	8*19 warrington	8*19 warrington
Tmin of OSG rope [N]	31500	31500	31500	31500	31500	31500